

# THE WILLOWBROOK 200

**AWARD  
WINNING  
DESIGN!**



Living Area	136.1m <sup>2</sup>
Garage Area	38m <sup>2</sup>
Alfresco Area	22.4m <sup>2</sup>
Patio Area	3.5m <sup>2</sup>
<b>Total Area</b>	<b>200.0m<sup>2</sup></b>



## FRESH FEATURES:

- 25 Year Structural Guarantee\*
- Quality European Appliances
- Designs can be modified to suit individual needs
- 6 Star Energy Rating
- Generous under roof entertainment area



**Fresh Homes**  
BUILT NEW JUST FOR YOU

Visit [FreshHomes.com.au](https://www.freshhomes.com.au) for the location of your nearest Fresh Homes Display Centre & Design Consultant.

Plan and images are for illustration purposes only and may show items that are not included. Floor plan and elevation shown in this brochure are artist impressions only and do not form any part of any offer or contract to build. Standard master plans and selected specifications take precedence over any artist impression, design, elevation or brochure. Designs and images are exclusively the property of Fresh Homes and as such are copyright. Prices and inclusions may change without notice.\*Applies to building structure only. QBCC1088603.

# THE WILLOWBROOK 200

4 

2 

2 

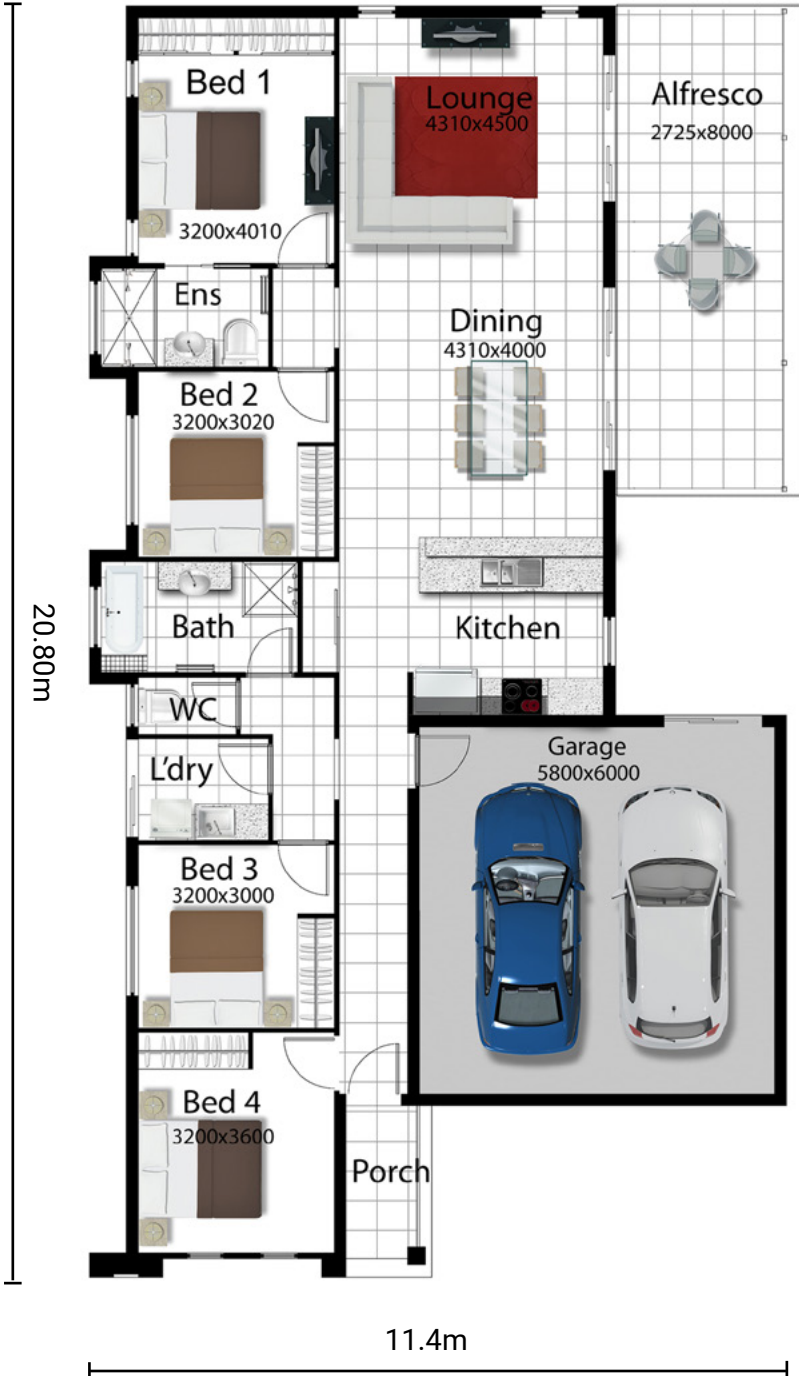

**House Width** 11.4m  
**Allotment Width\*** 13.5m  
*(minimum required)*

\* Minimum allotment width is indicative only and provided for general use as a guide only. Minimum allotment width may require reduced setbacks and may be subject to the developments plan of development and/or relevant state government development codes and/or local government by-laws. The builder provides no guarantee that a selected design will fit on a allotment regardless of the minimum allotment width provided by the builder. It remains the sole responsibility for Owners to ensure that any selected design will fit on their land.

**Living Area** 136.1m<sup>2</sup>  
**Garage Area** 38m<sup>2</sup>  
**Alfresco Area** 22.4m<sup>2</sup>  
**Patio Area** 3.5m<sup>2</sup>  
**Total Area** 200.0m<sup>2</sup>

**SE QLD PH:** (07) 3806 0603  
**Townsville PH:** (07) 4773 5865  
**Head Office:** 4067 Pacific Highway  
 Loganholme QLD 4129  
**Email:** [info@freshhomes.com.au](mailto:info@freshhomes.com.au)  
**Website:** [freshhomes.com.au](http://freshhomes.com.au)  
**QBCC licence:** 1088603

