

# LOT 82 LIRIOPE CRESCENT THE RESERVE | BOHLE PLAINS



**Fresh Homes**  
BUILT NEW JUST FOR YOU

**FOR  
SALE**

HOUSE AND  
LAND PRICE

**\$568,577**

4

2

2

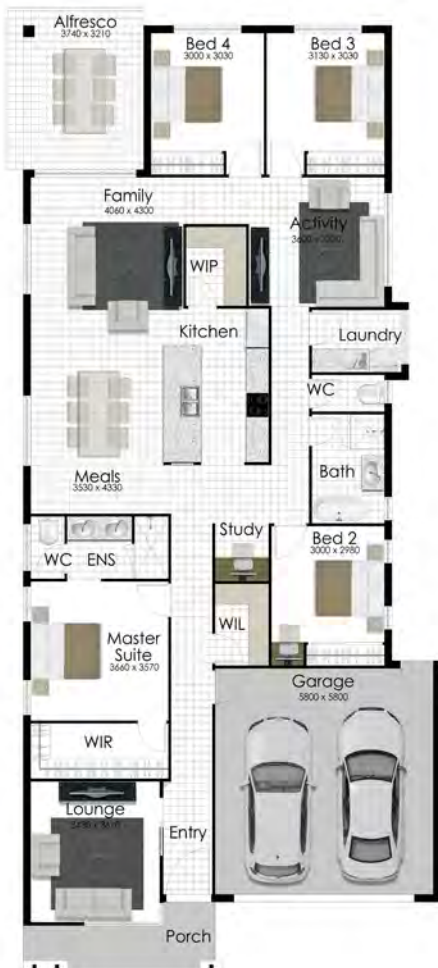

## THE EDEN 239

**LAND SIZE 419m<sup>2</sup>**

### PACKAGE INCLUDES:

- 25 Years structural guarantee\*
- Split System Air-Conditioning Throughout
- 1.2m Wide Entry Door
- 2.7m High ceilings
- Security Screens
- Window Key Locks
- Tiles to Porch
- Quality Tiles & Carpet
- CUSTOM made Kitchen by Moduline
- Stunning Stone Bench tops
- TECHNIKA quality cooking Appliances
- Double vanity to En-suite
- Luxury Tap ware
- NBN Connection
- SOLAR Ready
- LED Lighting/TV Antenna
- Smooth Render
- R2.5 Ceiling Insulation & Ventilated Eaves
- Double Auto Remote Control Garage
- Three Point Termite Protection

Living Area	183.27m <sup>2</sup>
Garage Area	27.03m <sup>2</sup>
Alfresco Area	11.85m <sup>2</sup>
Porch Area	7.41m <sup>2</sup>
<b>Total Area</b>	<b>239.54m<sup>2</sup></b>

- Wall Mount Clothesline
- Rendered Letterbox
- Built to Boundary
- Stone Aggregate Driveway
- Shared fencing
- Side gate access
- Landscape Garden to front
- Topsoil & Turf to front yard
- Irrigation to front yard

**TANIA BOOKER**

**PH: 0438 745 312**

tania.booker@freshhomes.com.au



**Fresh Homes**  
BUILT NEW JUST FOR YOU

Brisbane | Ipswich | Gold Coast | Sunshine Coast | Townsville

freshhomes.com.au

Plan and images are for illustration only. All elevations are masonry block with painted architectural textured coating. Brick finishes apply to SEQ only. Floor plan and elevation as shown in this brochure are artists impressions only and do not form any part of the contract to build. Standard plans and specifications take precedence over any design, elevation or brochure. These designs are exclusively the property of Fresh Homes and as such as copyright. QBCC1088603. Prices may change without notice. \*Applies to building structure only.