

THE MAYFAIR 185 LIFESTYLE SERIES

POPULAR
DESIGN!



Living Area	130.6m ²
Garage Area	35.7m ²
Alfresco Area	15.3m ²
Porch Area	4.0m ²
Total Area	184.75m²



FRESH FEATURES:

- 25 Year Structural Guarantee*
- Quality European Appliances
- Designs can be modified to suit individual needs
- 6 Star Energy Rating
- Generous under roof entertainment area



Fresh Homes
BUILT NEW JUST FOR YOU

Visit [FreshHomes.com.au](https://www.freshhomes.com.au) for the location of your nearest Fresh Homes Display Centre & Design Consultant.

Plan and images are for illustration purposes only and may show items that are not included. Floor plan and elevation shown in this brochure are artist impressions only and do not form any part of any offer or contract to build. Standard master plans and selected specifications take precedence over any artist impression, design, elevation or brochure. Designs and images are exclusively the property of Fresh Homes and as such are copyright. Prices and inclusions may change without notice.*Applies to building structure only. QBCC1088603.

THE MAYFAIR 185 LIFESTYLE SERIES

4 

2 

2 

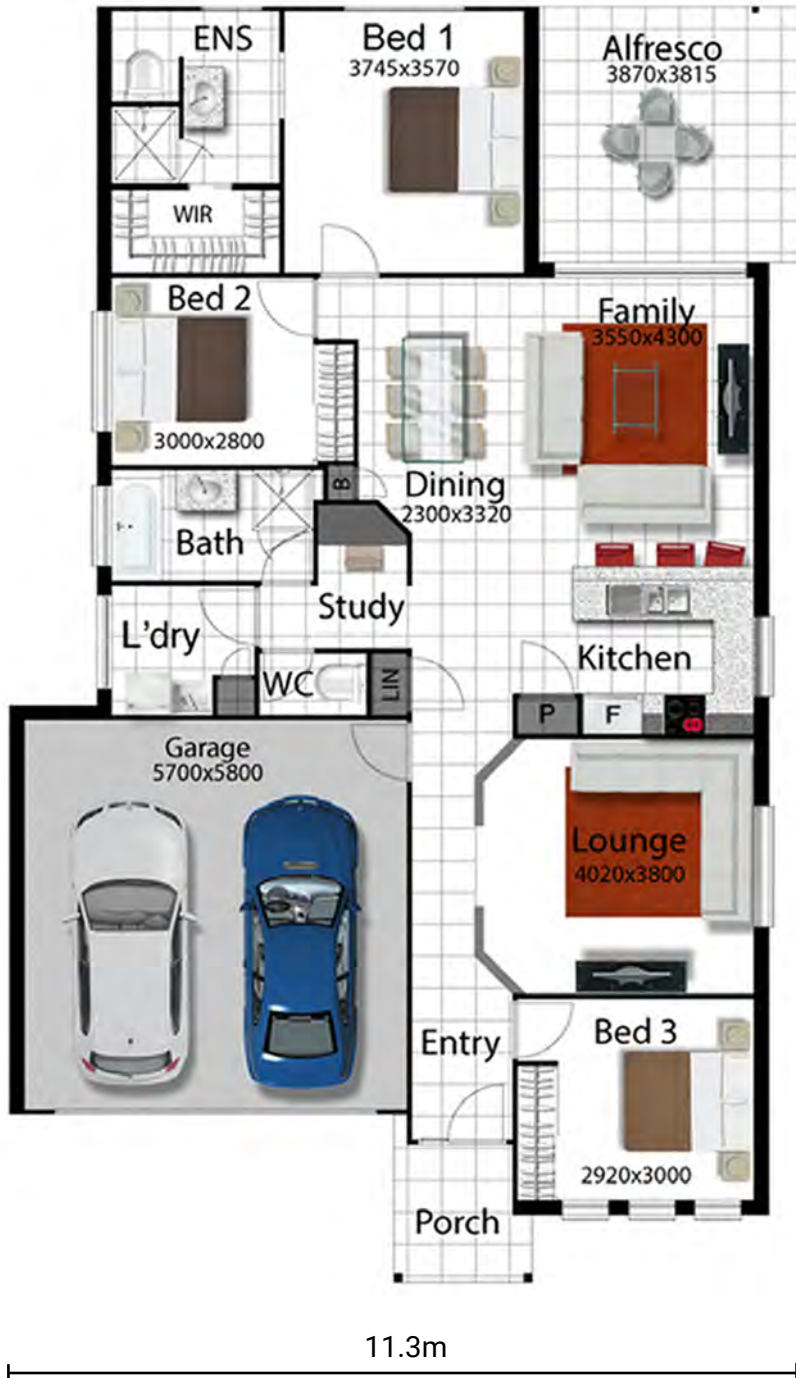

House Width 11.3m
Allotment Width* 12.5m
(minimum required)

* Minimum allotment width is indicative only and provided for general use as a guide only. Minimum allotment width may require reduced setbacks and may be subject to the developments plan of development and/or relevant state government development codes and/or local government by-laws. The builder provides no guarantee that a selected design will fit on a allotment regardless of the minimum allotment width provided by the builder. It remains the sole responsibility for Owners to ensure that any selected design will fit on their land.

Living Area 130.6m²
Garage Area 35.7m²
Alfresco Area 15.3m²
Porch Area 4.0m²
Total Area 184.75m²

SE QLD PH: (07) 3806 0603
Townsville PH: (07) 4773 5865
Head Office: 4067 Pacific Highway
 Loganholme QLD 4129
Email: info@freshhomes.com.au
Website: freshhomes.com.au
QBCC licence: 1088603

